



Upgrading Solid Walls (Externally)

Wall Insulation

Celotex
Insulation Specialists

Introduction

Celotex is the brand leading manufacturer of PIR insulation boards, with its range encompassing the thinnest and thickest boards available to the construction industry today. All of the Company's products are manufactured at its plant in Suffolk, from where the dedicated Celotex Technical Centre offers advice and calculations for compliance with current regulations and legislation.

Celotex: We know insulation inside and out.

Use **Celotex SW3000** high performance thermal insulation in solid masonry external wall upgrades to minimise insulation thickness and give the following benefits:

- Achieve compliance with Building Regulations whilst ensuring thin solutions
- Deliver thinner solutions and better U-values compared to many other insulation materials
- Directly render to insulation with no requirement for separate render boards or batten systems
- Particularly suited for refurbishment projects
- Provides a highly efficient insulation solution without impacting on internal living space
- Provides reliable long term energy and cost savings

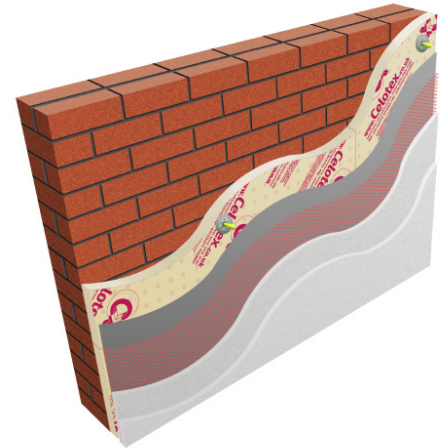

Celotex SW3000

Celotex SW3000 Technical Data

Product Code	Thickness (mm)	R-value (m ² K/W)	Weight (kg/m ²)
SW3050	50	1.85	2.04
SW3080	80	3.05	3.00
SW3100	100	3.80	3.64

Example U-value Calculation: External Solid Walls

Construction	Thickness (mm)	
Outside surface resistance	-	
Render	20	
Variable layer	See below	
Brickwork	215	
Plaster, lightweight	13	
Inside surface resistance	-	
Variable layers	Thickness (mm)	U-value (W/m ² K)
Celotex SW3000	80	0.28*
Celotex SW3000	100	0.23*

* Assumes thermally broken fixings

Sustainable Insulation

Celotex PIR insulation has been independently assessed by BRE Global and has been accredited with an A+ rating when compared to the BRE Green Guide.

The results also show that Celotex offers a lower environmental impact than other typical PIR manufacturers.

For further information about Celotex' sustainable insulation solutions, visit the sustainability pages of the website at celotex.co.uk



cont...



Upgrading Solid Walls (Externally)

Wall Insulation

Celotex
Insulation Specialists

Installation Guidelines

Celotex insulation boards should not be installed when the temperature is at or below 4°C and falling.

- Prior to installation of the Celotex insulation boards, the substrate must be checked for soundness.
- Large, uneven projections should be removed and all holes filled and levelled. Loose materials should be cleaned off to leave a sound, dry surface.
- Downpipes should be temporarily removed and, if necessary, relocated after completion of installation. Lengthening of overflow pipes should be allowed for, together with extension to sills.
- Celotex SW3000 should be installed with the perforated facer facing outwards to accept the render system.
- SW3000 should be fixed to the substrate using proprietary fasteners, which are driven into pre-drilled holes.
- SW3000 should be fitted with a minimum of 5 fixings per board. One fixing should be located towards each corner of the board with one fixing in the centre of each board. Fixings should be installed between 50mm - 150mm from the corners and edges of the board. Fixings must not be installed through board joints.
- All insulation board joints should be tightly butted and end joints staggered.
- Celotex SW3000 is designed for use with compatible render systems. Details of compatible render systems can be provided by the Celotex Technical Centre. SW3000 is not designed for use with a standard sand and cement render.
- The render systems should then be applied in accordance with manufacturer's guidelines.

Further Information

If you wish to contact Celotex, please visit celotex.co.uk and click on the 'contact us' page.

For information regarding [storage, installation and handling](#) of Celotex products, or for [Health and Safety](#) advice, please refer to the 'literature' pages of the website at celotex.co.uk

Celotex has a policy of continuous product development and reserves the right to alter product designs or specifications without prior notice.