

Celotex Crown-Up is a brand new product for use in flat roof systems. Representing the next phase of Celotex innovation, Crown-Up is a high performance rigid polyisocyanurate (PIR) insulation which delivers excellent dimensional stability and added robustness in a built-up flat roofing system.

Celotex Crown-Up flat roof PIR insulation has the following product features:

- Low lambda range between 0.025-0.027W/mK offering high thermal performance
- Suitable for built-up flat roofing systems including bituminous based and mastic asphalt applications
- Excellent compressive strength, delivering increased dimensional stability and added robustness
- An extensive package of online support, tools and aftercare

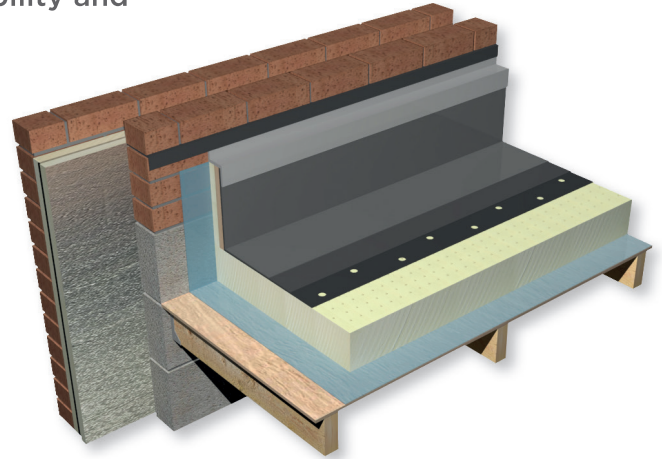

Applications

- ✓ Suitable to be used on fully sealed metal, timber and concrete decks
- ✓ Compatible with bituminous based and mastic asphalt applications
- ✓ Secured to the deck with fully bonded systems or mechanical or thermally broken fasteners

Specification clause

The insulation shall be Celotex Crown-Up ____mm thick comprising of polyisocyanurate rigid foam insulation core with a thermal conductivity of 0.025-0.027W/mK and mineral coated glass tissue facings on both sides. Crown-Up is CFC/HCFC free with zero ODP and low GWP and CE marking compliance to BS EN 13165. Crown-Up is manufactured in accordance with quality management system ISO 9001 and environmental management system ISO 14001. All products must be installed in accordance with instructions issued by Celotex.

Technical data

Thickness (mm)	R-value (m ² K/W)	Weight (kg/m ²)
100	3.80	4.29
120	4.80	5.06
150	6.00	6.22

Physical properties

Compressive strength	≥150kpa
Dimensional stability	DS(70,90)3 - DS(-20-)1
Thermal conductivity	<80mm - 0.027W/mK 80-119mm - 0.026W/mK ≥120mm - 0.025W/mK
Board size	600 x 1200mm

Typical U-values

U-values will vary depending on application. To calculate a specific U-value, please visit our online calculator at celotex.co.uk

Installation guidelines

For Celotex Crown-Up installation details please refer to our online 'applications' pages.

Further information

If you wish to contact Celotex, please do so through the 'contact us' page on our website.

For information regarding storage, installation and handling of Celotex products, or for health & safety advice, please refer to our online 'literature' pages.

Celotex has a policy of continuous product development and reserves the right to alter product designs or specifications without prior notice.

Saint-Gobain Construction Products UK Limited trading as Celotex. Registered Office: Saint-Gobain House, Binley Business Park, Coventry CV3 2TT. Registered in England and Wales No 734396