



## Celotex GD5000

Plasterboard Thermal Laminate Insulation Board

**Celotex**  
SAINT-GOBAIN

## Introduction

Celotex GD5000 is a plasterboard thermal laminate comprising of premium PIR insulation bonded to 12.5mm tapered edge plasterboard. Designed specifically for internal dry-lining systems, GD5000 can be used to upgrade internal solid walls or provide a second layer of insulation including timber frame constructions and between and under pitched and flat roof applications.

Featuring a super low lambda performance of 0.021 W/mK with aluminum foil/kraft paper facings, Celotex GD5000 is ideal for achieving better U-values and thinner solutions in adhesively bonded (dot & dab) applications. GD5000 is manufactured from rigid polyisocyanurate (PIR) using a blowing agent that has low global warming potential and zero ozone depletion potential.

With Celotex GD5000 you are specifying an insulation board that:

- Offers the highest performing PIR plasterboard thermal laminate
- Certified under BBA certificate number 12/4926 and is Ofgem approved
- Is suitable for achieving thinner solutions in plaster dab bonded and direct mechanically fixed dry lining applications
- Available and accredited for a wide range of installation techniques providing speed and flexibility to the installer, offering time and cost savings
- Uses 50% less insulation than some other certified systems helping optimise internal living space
- Can achieve up to 30% better U-values using comparable build ups, assisting in delivering enhanced carbon savings
- Allows common target U-values to be met with the thinnest possible solution
- Offers up to 15% thinner solutions than typical PIR

## Applications

Celotex GD5000 is purpose designed for providing better U-values and thinner solutions in adhesively bonded solid wall upgrades and other dry-lining applications. These include, timber frame constructions and the underneath layer of between and under build-ups in pitched and flat roofs.

## Specification Clause

The insulation shall be Celotex GD5000 \_\_\_\_\_mm thick comprising a polyisocyanurate rigid foam insulation core with a thermal conductivity of 0.021W/mK with aluminium foil/kraft paper facings on both sides bonded to a layer of 12.5mm tapered edge plasterboard. Celotex GD5000 is CFC/HCFC free with zero ODP and low GWP and CE marking compliance to BS EN 13950. Celotex GD5000 is manufactured in accordance with quality management system ISO 9001 and environmental management system ISO 14001. All products must be installed in accordance with instructions issued by Celotex.

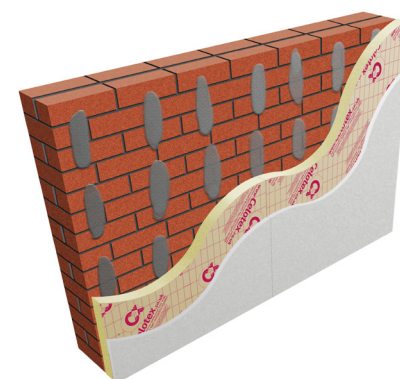

Celotex GD5000 in a internal solid wall application

## Sustainable Insulation

Celotex PIR insulation has been independently assessed by BRE Global and has been accredited with an A+ rating when compared to the BRE Green Guide.

The results also show that Celotex offers a lower environmental impact than other typical PIR manufacturers.

For further information about Celotex' sustainable insulation solutions, visit the sustainability pages of the website at [celotex.co.uk](http://celotex.co.uk)

cont...



## Celotex GD5000

Plasterboard Thermal Laminate Insulation Board

**Celotex**  
SAINT-GOBAIN

### Celotex GD5000 Technical Data

Product Code	Thickness (mm)	R-value (m <sup>2</sup> K/W)	Weight (kg/m <sup>2</sup> )
GD5025	25 + 12.5	1.25	9.18
GD5040	40 + 12.5	1.95	9.66
GD5050	50 + 12.5	2.40	9.98
GD5060	60 + 12.5	2.90	10.33

### Physical Properties (\*insulation only)

	Method	GD5000
Compressive strength*	BS EN 826	≥120kPa
Dimensional stability*	BS EN 1604	DS(TH)8
Thermal conductivity*	BS EN 12667	0.021W/mK
Fire resistance	BS EN 13501-1	Euroclass B-s1,d0

### Typical U-values

U-values will vary depending on application. To calculate a specific U-value, please visit our online U-value calculator at [celotex.co.uk](http://celotex.co.uk)

### Installation Guidelines

Installation of Celotex GD5000 will depend on the application and installation type.

### Further Information

If you wish to contact Celotex, please visit [celotex.co.uk](http://celotex.co.uk) and click on the 'contact us' page.

Care and preventative measures should be taken when lifting and installing Celotex GD5000 due to the weight of the plasterboard. For information regarding [storage](#), [installation and handling](#) of Celotex products, or for Health & Safety advice, please refer to the '[literature](#)' pages of the website at [celotex.co.uk](http://celotex.co.uk).

Celotex has a policy of continuous product development and reserves the right to alter product designs or specifications without prior notice.

**Celotex**  
Lady Lane Industrial Estate,  
Hadleigh, Ipswich  
Suffolk IP7 6BA

**T: 01473 820850**  
**W: [celotex.co.uk](http://celotex.co.uk)**