



Celotex SW3000

External Wall Insulation Board

Celotex
Insulation Specialists

Introduction

Celotex SW3000 is the perfect solution for the thermal upgrade of external solid walls. It provides a quick and easy method of achieving effective thermal insulation in external solid wall constructions where no insulation currently exists.

With coated glass tissue facings, SW3000 is manufactured from rigid polyisocyanurate (PIR) using a blowing agent that has zero ozone depletion potential (zero ODP) and a low global warming potential (GWP).

With Celotex SW3000, you are specifying insulation board that:

- Achieves compliance with Building Regulations whilst ensuring thin solutions
- Deliver thinner solutions and better U-values compared to other insulation materials including mineral fibre and EPS
- Direct render solution with no requirement for separate render boards or batten systems
- Particularly suited for refurbishment projects
- Provides a highly efficient insulation solution without impacting on internal living space
- Provides reliable long term energy and cost savings

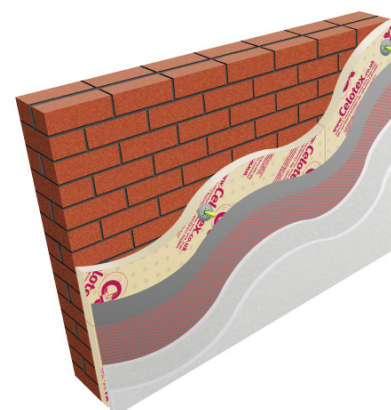

Celotex SW3000 in an external solid wall application

Applications

Celotex SW3000 is purpose designed for use in external solid wall applications.

Specification Clause

The insulation shall be Celotex SW3000 _____mm thick comprising a polyisocyanurate rigid foam insulation core with a thermal conductivity of 0.026 - 0.027 W/mK with mineral coated glass tissue facings on both sides. Celotex SW3000 is CFC/HCFC free with zero ODP and low GWP and CE marking compliance to BS EN 13165. Celotex SW3000 is manufactured in accordance with quality management system ISO 9001 and environmental management system ISO 14001. All products must be installed in accordance with instructions issued by Celotex.

Celotex SW3000 Technical Data

Product Code	Thickness (mm)	R-value (m ² K/W)	Weight (kg/m ²)
SW3050	50	1.85	2.04
SW3080	80	3.05	3.00
SW3100	100	3.80	3.64

Sustainable Insulation

Celotex PIR insulation has been independently assessed by BRE Global and has been accredited with an A+ rating when compared to the BRE Green Guide.

The results also show that Celotex offers a lower environmental impact than other typical PIR manufacturers.

For further information about Celotex' sustainable insulation solutions, visit the sustainability pages of the website at celotex.co.uk



cont...



Celotex SW3000

External Wall Insulation Board

Celotex
Insulation Specialists

Physical Properties

	Method	SW3000
Compressive strength	BS EN 826	≥150kPa
Dimensional stability	BS EN 1604	DS(TH)8
Water vapour resistance	BS EN 12086: Method B	>20 MNs/g
Thermal conductivity	BS EN 12667	0.027 W/mK <80mm 0.026 W/mK 80mm - 100mm

Typical U-values

U-values will vary depending on application. To calculate a specific U-value, please visit our online U-value calculator at celotex.co.uk

Installation Guidelines

For full details of the installation of Celotex SW3000, please refer to the 'applications' pages of the website at celotex.co.uk

Further Information

If you wish to contact Celotex, please visit celotex.co.uk and click on the 'contact us' page.

For information regarding [storage](#), [installation and handling](#) of Celotex products, or for Health & Safety advice, please refer to the 'literature' pages of the website at celotex.co.uk.

Celotex has a policy of continuous product development and reserves the right to alter product designs or specifications without prior notice.

Celotex Limited
Lady Lane Industrial Estate,
Hadleigh, Ipswich
Suffolk IP7 6BA

T: 01473 820850
W: celotex.co.uk