



Customer Service

UK Freephone: 0800 521 050
UK Freefax: 0800 521 205
Eire Tel: 01 4620739
Eire Fax: 01 4620745
Email: cservice@knauf.co.uk

Technical Service

UK Tel: 01795 416 259
Eire Tel: 01 4620739
Email: technical@knauf.co.uk

Literature

UK Tel: 08700 613 700
Eire Tel: +44 8700 613 700

Website

www.knauf.co.uk
www.knauf.ie

Knauf
Kemsley Fields Business Park
Sittingbourne
Kent ME9 8SR

Knauf
87 Broomhill Road
Tallaght
Dublin 24

Knauf Factory Locations

Ridham Dock
Sittingbourne
Kent

Queens Road
Immingham
N.E. Lincolnshire



© Copyright Knauf 2012

The information given in this publication is believed to be current and accurate as at the date of publication, but no warranty, express or implied is given. Updates will not be automatically issued.



This document is printed on 80% recycled paper



Instant thermal upgrade

Easy to install

Reduces installation time

Offers energy savings

Various solutions for all requirements

Knauf Insulating Laminates
A complete range of high performance
insulated plasterboard

Build for the world we live in

Knauf Insulating Laminates Factsheet

The Knauf Drywall Insulating Laminates range is designed to instantly enhance thermal insulation, for both wall and roof linings. The range offers a fast and effective way to comply with Building Regulations and work towards the Code for Sustainable Homes.

With the additional benefits of improved air-tightness and better sound insulation, Knauf Drywall Insulating Laminates provide comprehensive answers for a range of building requirements. And, once easily installed, the rapid payback period speaks for itself.

Complying with Approved Document L

All new dwelling and non-dwelling constructions, as well as a great many refurbishment projects, are required to meet Approved Document L, Domestic Technical Handbook Section 6, Technical Standard F1 or Technical Guidance Document L. Our Insulating Laminates reduce energy expenditure and help meet the Building Regulations requirements, whilst maximising internal usable space.

Code for Sustainable Homes

The Code for Sustainable Homes requires progressive improvement to efficiency levels in new build housing, culminating in level 6 – carbon neutral homes – in 2016.

Upgrading a single typical residential house can reduce CO₂ output by approximately 0.5 to 3 tonnes a year. Much bigger reductions are seen with older office blocks, industrial buildings and residential towers.

Thermal performance

The range of Knauf Insulating Laminates incorporates a 9.5mm tapered edged Knauf Wallboard bonded to a variety of different types and thicknesses of insulation to ensure the required U-value is reached for the minimum impact on room space.



How to fix

Knauf Insulating Laminates can be fixed using the Knauf Direct Bonding system to line brick or block walls, or mechanically fixed directly to timber in new, refurbished or extended residential and commercial buildings.

For roof linings, Knauf Insulating Laminates are mechanically fixed directly over rafters, with additional Knauf insulation between the rafters.

Technical support

Knauf Drywall provides full technical service backup. If you need support with U-value calculations or producing solutions in your projects to meet relevant approvals, you can contact Knauf Technical Services on 01795 416 259 or email technical@knauf.co.uk

Specifying Knauf Insulating Laminates

One of the simplest ways to meet regulatory requirements and contribute towards the Code for Sustainable Homes is to specify Knauf Insulating Laminates. The range of quick-to-install Insulating Laminates provides instant cost effective dry lining and insulation in one board.

Product facts

- CFC/HCFC free
- Zero Ozone Depletion Potential
- Suitable for direct-fix or dot-and-dab installation
- Low Global Warming Potential

Where to use Knauf Insulating Laminates

New build

Refurbishment - walls or roofs

Retro-fit to older properties

Upgrading existing stock

Warm roof solutions or conversions

Areas where a substantial thermal upgrade is required



Benefits

- Quick and easy to install on site
- Suitable for direct-fix or dot-and-dab installation
- Provide an instant thermal upgrade
- Perfect for complying to Approved Document L and similar regulations
- Help to significantly reduce energy usage in the future
- Ideal for insulating around window reveals
- Excellent for use with timber frame construction

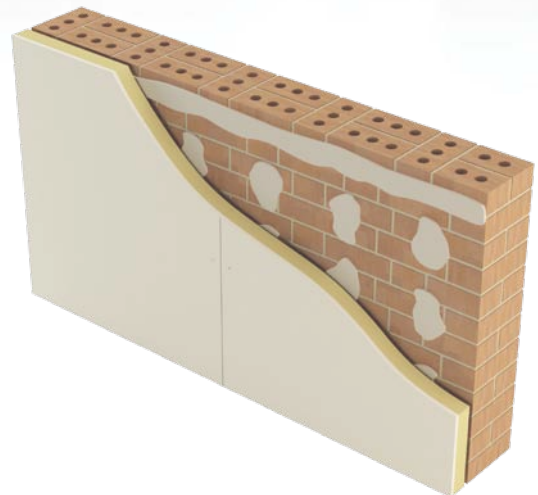

	P'board Thickness (mm)	Laminate Thickness (mm)	Length (mm)	Width (mm)	Moisture Resistance MNs/g	Thermal Conductivity (W/mK)	R Value (m ² K/W) Exact	R Value (m ² K/W) Rounded	kg/m ²
Knauf Thermal Laminate This product is made of high-quality expanded polystyrene to provide improvements in thermal performance.	9.5	22	2400	1200	n/a	0.038	0.37	0.35	6.3
	9.5	30	2400	1200	n/a	0.038	0.58	0.55	6.4
	9.5	40	2400	1200	n/a	0.038	0.85	0.85	6.5
Knauf Thermal Laminate (Vapour Check) This Vapour Check product has an added layer to reduce the risk of condensation whilst upgrading thermal insulation.	9.5	22	2400	1200	78	0.038	0.37	0.35	6.3
	9.5	30	2400	1200	78	0.038	0.58	0.55	6.4
	9.5	40	2400	1200	78	0.038	0.85	0.85	6.5
Knauf XPS Laminate Plus Offering enhanced thermal resistance, our XPS Laminate Plus product is made of high-quality extruded polystyrene with the additional benefit of strength and robustness.	9.5	27	2400	1200	9.0	0.033	0.58	0.55	6.8
	9.5	35	2400	1200	12.8	0.033	0.82	0.80	7.1
	9.5	40	2400	1200	15.3	0.033	0.97	0.95	7.3
	9.5	45	2400	1200	17.8	0.033	1.13	1.10	7.4
	9.5	55	2400	1200	22.5	0.033	1.43	1.40	7.6
Knauf PIR Laminate Made of high-quality Polyisocyanurate, Knauf PIR Laminate provides excellent thermal resistance - an extremely cost-effective solution which can be used for all applications.	9.5	35	2400	1200	150	0.022	1.21	1.20	6.9
	9.5	50	2400	1200	150	0.022	1.87	1.85	7.4
	9.5	65	2400	1200	150	0.022	2.55	2.55	7.8
	9.5	75	2400	1200	150	0.022	3.00	3.00	8.1